

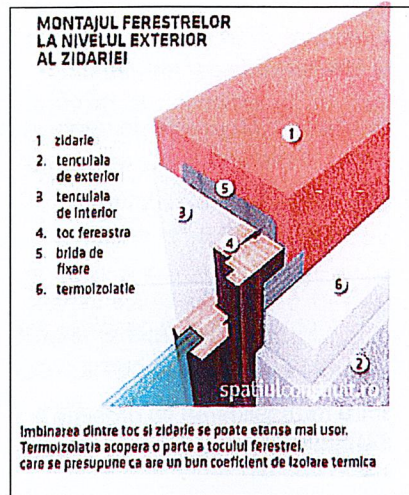

Conform raport de AUDIT ENERGETIC

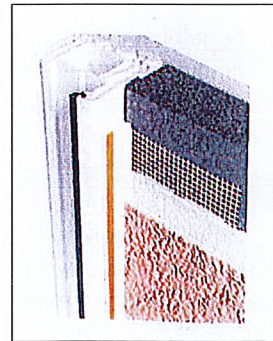

Conform raport de AUDIT ENERGETIC



Conform raport de AUDIT ENERGETIC

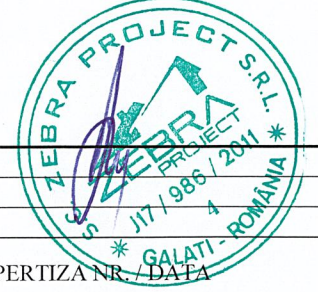
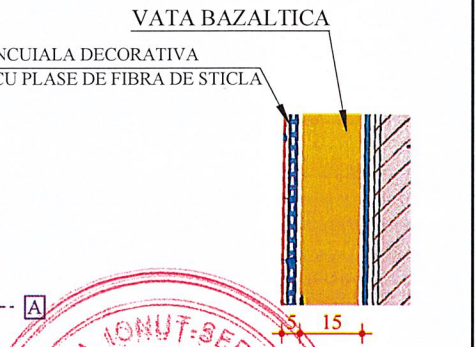
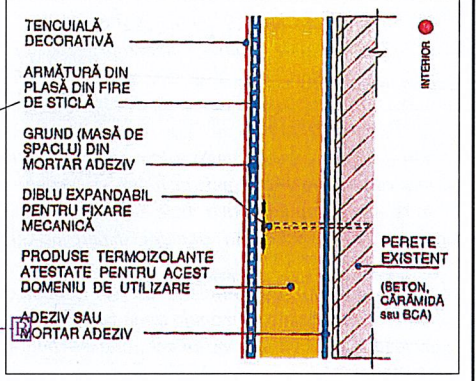
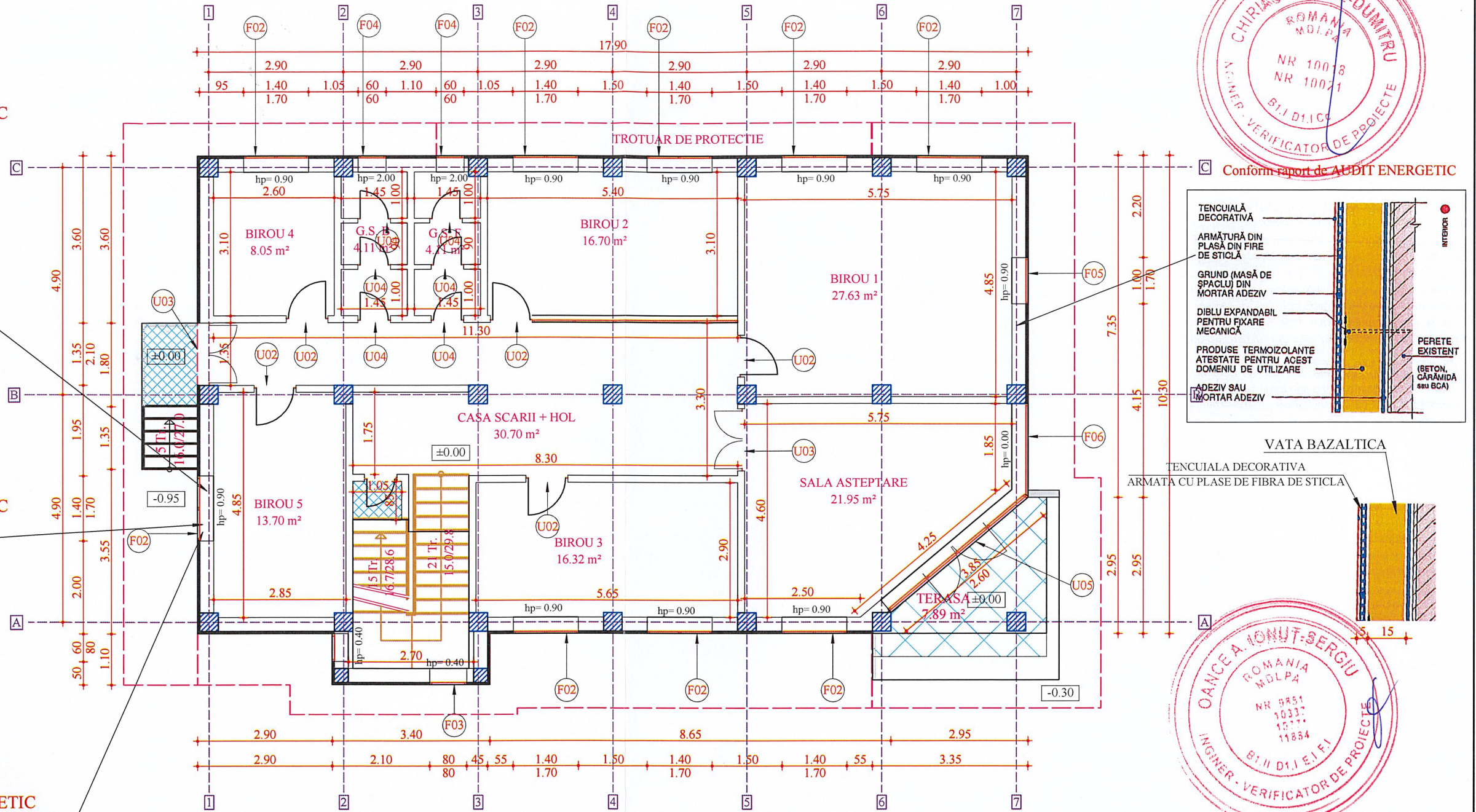
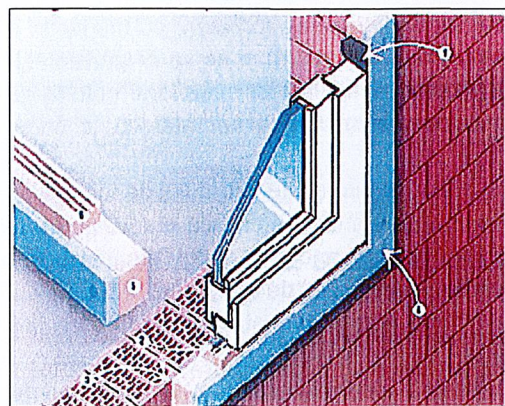

PLAN PARTER

Suprafata construita = 188.00 mp

VERIFICATORI EXPERT	NUME	766 Ion BANAS SEMNATURA cu drept de semnatura	CERINTA	REFERAT / EXPERTIZA NR. / DATA	Proiect nr.: 375/2023
ZEBRA PROJECT J17/986/2011			RO28921919	Beneficiar: U.A.T. SMARDAN	Faza: P.Th.
SPECIFICATIE	NUME	SEMNATURA	SCARA: 1:100	Titlu proiect: IMBUNATATIREA EFICIENTEI ENERGETICE A SEDIULUI PRIMARIEI COMUNEI SMARDAN, JUDETUL GALATI.	Plansa nr.: A04'
SEF PROIECT	arh. BANAS I.			Com. Smardan, Sat. Smardan, Jud. Galati	
PROIECTAT	arh. BANAS I.		DATA: NOIEMBRIE 2023	Titlu plansa: PLAN PARTER SITUATIE PROPUA	
DESENAT	ing. Dorin CUTULAB				